

Hello Summer!

From The Staff

Place
Refrigerator
Magnet
HERE

at Shires Housing

IMPORTANT PHONE NUMBERS

Shires Housing Office: 802-442-8139

Regular Maintenance Requests: 802-442-8139 ext. 4

EMERGENCY MAINTENANCE DURING BUSINESS HOURS - 802-442-8139 ext. 0

AFTER HOURS EMERGENCY MAINTENANCE ONLY - 1-844-256-4706

(stoves, refrigerators, and cable hookups are not considered emergencies)

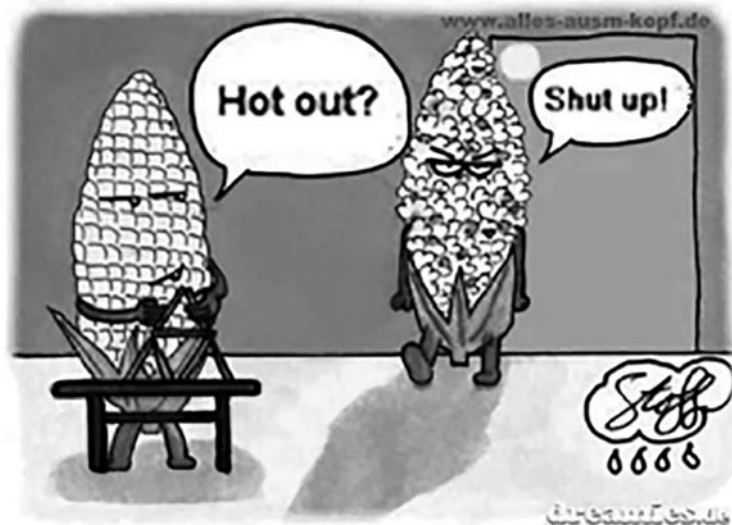

Keep It Simple.

Our mission is simple. We provide top-quality apartments at prices that fit the budgets of regular working folks. Anything we can do as a community to improve the quiet enjoyment of your home, to keep costs low, and to improve our environment to be safe and welcoming for everyone is what we want to hear from you. Thank you!

We Want Your Thoughts & Feedback!

Stop by, call, write, or e-mail us!

Our Shires Housing office is located at 302A South Street.
Mail: Shires Housing, P.O. Box 1247 • Bennington, VT 05201
Phone: 802-442-8139 • Fax 802-442-5125
www.shireshousing.org • info@shireshousing.org



Newsletter

EQUAL HOUSING
OPPORTUNITY
Vol. 3, No. 3
Summer 2016

Refer a Friend and Earn \$100!

Do you have a friend or a relative who wishes they had a nicer place to live? A more affordable place to live? You should let them know about Shires Housing – and have them tell us that you referred them!

If you refer a friend or relative, and they end up signing a lease with us, we'd like to thank you by giving you \$100 off your next month's rent.* There is no limit to the number of friends and relatives you can refer, so feel free to earn as many referral fees as you can!

We've given out hundreds of dollars in referral rewards in the last few months alone. So what are you waiting for? Refer a friend today; your friends and relatives will thank you, and so will we... along with an nice \$100 credit off your next month's rent!

Refer a Friend
to Shires Housing
and get
\$100.00 OFF
Your Next Month's
Rent!*

*Available after your referral results in a signed lease with Shires Housing.

Enjoy Biking — Safely!

Ah, what better way to enjoy summer than to get outside and bike around! But while being outside is beneficial in many ways, parents and babysitters need to make sure to be on hand for when they are needed.

Kids are kids, and one thing that we all know is true is that the unexpected is guaranteed to happen. That is why children should be supervised at all times.

On the bright side, not only is spending time outside with kids potentially valuable

Your child's safety is our number one concern!

quality time for families, it also has many teaching moments that present themselves. For example, make sure to discuss the proper ways to use a bike responsibly. Teach them to wear a helmet and what to look out for. Show how to

be aware of ones surroundings to avoid accidents, or damage to lawns or gardens. And finally, demonstrate how to have fun on bikes, while staying safe.

So get outside! Have fun, and most importantly, stay safe!

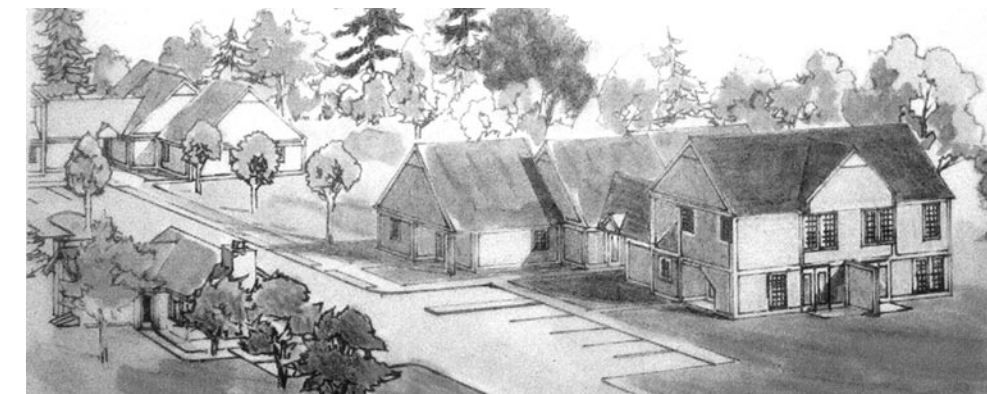

On-Site Property Managers

One of the many advantages of renting an apartment from Shires Housing is the availability of their maintenance staff. You can call to request regular maintenance by calling the office during regular business hours, or call the toll-free hotline anytime for emergencies (see back page for details).

In addition, residents living in Manchester and Arlington also have on-site property managers. These managers are your first line of defense! If you have any is-

Make use of your property manager for your small maintenance tasks!

sues or problems, you can get immediate answers or help by contacting them first. They will do their best to help you right away. They can handle most basic maintenance tasks on your behalf without your needing to call and schedule a regular maintenance

appointment. If you've not yet met your manager... contact them and say hello!

Mark Wade, Manchester: 688-3542
Chip & Leslie Andrew, Arlington: 375-4917

INSIDE: New Maintenance Director Hired

Summer ROCKS! But not at 50 miles an hour

Summer you truly rock! But did you know that items thrown from a lawn mover can achieve speeds of 50 miles an hour or more? Yikes! So do everyone a favor and avoid moving rocks from roadways onto the lawns where they can be swept up and shot out by a passing lawn mower. You will be glad you did!

Manchester Knoll & Manchester Commons Laundry Room Update

We've been busy making improvements to our laundry rooms. You can help by letting us know whenever you encounter a problem with a washing machine or dryer! For Manchester Knoll and Manchester Commons, we have now marked all the machines to identify them. Simply reference these new markings when calling about any issues, and we will take care of them for you!

Also a reminder that for your safety and the safety of your belongings, we ask that the laundry rooms remain locked at all times. Makes sense, right?



* Service/Companion dogs are allowed.

Do's and Don'ts of Dumpsters

Another great advantage of Shires Housing is the garbage removal service that is included in your regular rent. There are just a few important dos and don'ts that you need to be aware of:

THINGS NOT TO DO:

The biggest thing NOT to do is literally a big thing... don't try throwing out things like a mattress in the dumpster... it won't work! They won't accept it and it will end up back in your hands. Here is a thought; when you buy a new mattress, see if they will take back your old one. That is a valuable service that will save you time and money!

The other thing is to never throw out electronic devices, such as old TVs or computers. All of those sort of items can be recycled for FREE at the town transfer station on Houghton Lane in Bennington. Recycling electronic devices is a great way to help save the world by recycling these items.

THINGS TO DO:

Make sure to break down any cardboard boxes so they are flat before putting them in the dumpster. This allows everyone to fit more items in without overcrowding. You will be happy and your neighbors will be happy!

FIRE HAZARD:

Air Fresheners Warning

Plug in air fresheners are nice, pretty and also a possible fire hazard! They are prohibited by Shires Housing in order to protect your safety.



Help Save The World... From your BATHROOM!

Have you listened to your toilet lately? Crazy right? Believe it or not, leaking toilets are the number one water waster for Shires Housing! The best way to find out if your toilet is leaking, is to listen to it.

That's right! Unlike other leaks that you can see right there on the floor or counter, a leaky toilet does not LOOK like it is leaking at all. For toilets you need to listen carefully... once the bowl is full, do you still HEAR the sound of running water? If you do, then you have a toilet leak.

Be a hero! Call us right away, and we will schedule an appointment to come right over and fix it for you... at NO CHARGE. Having your toilet leak fixed is 100% free for you... and even better, it's 100% good for the environment! So help save the world... and listen to your toilet!

While you are busy saving the world, here is another great tip that you can do easily yourself... become a fan of your fan!



Look up at your bathroom fan; is it dirty? Buildup of dirt and dust renders your fan inefficient. So easy to fix! Simply vacuum out the fan intake areas and you will be running at maximum efficiency in no time at all.

So there you have it... two quick ways you can help save the world from your bathroom!

Lakes and Swimming Holes

Best way to beat the heat in summer is to head to your nearest water hole and jump in! For small kids we recommend **Lake Shaftsbury State Park** with its wide sandy beach suitable for castle building, large shallow end, and snack bar. Nice facilities, picnic areas, boat rentals, and grills. Fee charged. No lifeguard on duty.

For later in the summer as things heat up, you may prefer **Lake Paran** in North Bennington. This lake is deeper and stays refreshingly cold. A small fee is charged. Snack bar, facilities, and a lifeguard. Kayak and canoe rentals available.

For a more adult experience, a favorite spot is the **Dorset Quarry** on Route 30 in Dorset. NOT for children, this very deep quarry is ringed by cliffs and is an amazing, beautiful place to swim. No facilities, no conveniences, and no charge.

Another place to cool off is in the **Roaring Branch River**, on Route 9, east of Bennington. Park along the highway (on the south side, or your right coming from Bennington), near where you see the sign for the National Forest. A series of informal trails lead to a number of shallow swimming holes along the river. River temperatures range from frigid in the early summer to



A leap of faith off the dock at Lake Paran.

cold in the late summer. Not for very small children, but a fun experience for elementary age children with adult supervision. This is on National Forest lands and there are no facilities, no fees, and you are expected to pack out whatever you pack in.

Emerald Lake State Park is also a good choice. Located north of Manchester, this deep lake is nestled on the east slope of Dorset Mountain. There is an admission, but it has amenities that make this family friendly, including snack bar and boat rentals.

New Maintenance Director Hired



Maintenance Director Joel Pacher.

Joel Pacher comes to us, having over 25 years of experience in designing and delivering engineering solutions for major construction projects; specializes in HVAC / Heating and Cooling, electrical and plumbing. He has worked around the Bennington and Stratton Mountain areas in the past and we are happy to announce that he is now our new Maintenance Director for Shires Housing.

He enjoys his grandchildren, gardening and his own collection of animals, such as chickens and ducks!! Welcome, Joel!! We look forward to a long and productive career with Shires Housing!!

REMINDER: Maintenance Personnel are on site for a SPECIFIC purpose

If you have a maintenance concern, DO NOT ask the maintenance personnel to address your issue if you see them around your building. They have specific work orders to complete when you see them and cannot deviate from their "to do" lists. ALL maintenance issues MUST be reported to the Shires Housing main office first.

The Bulletin Board

Now that the days of summer are upon us, we wanted to remind you of some of the basic rules to remember.

Why All The Rules?

Frankly, we don't love rules, but when it comes to your safety and peaceful enjoyment of your housing, we will do everything in our power to make your housing a great place to live!

No Dogs Allowed – This one is tough for us dog lovers! Sadly, no dogs are allowed in Shires Housing, not even to visit. Sorry fido!

Gardens – Digging is prohibited on lawns. No vegetable gardens are allowed.

Potted Flowers – All plants must be located neatly in their area. Walkways sidewalks, etc. will not be allowed to be blocked with any plants or flowerpots.

Hoses – Hoses are NOT permitted!

Water – Please be conscious of excessive water usage.

BBQ's/Grills – must be in the backyard. BBQ's/grills cannot be within 10 ft of the building.

No clothes lines.

Vehicles must be parked in provided parking areas, off all grassy locations.

No tag sales.

Remove toys and clutter. Any flowers mowed over will not be the responsibility of Shires Housing.

